

# 1.27 Series

## Shrouded Header With Eject Latch

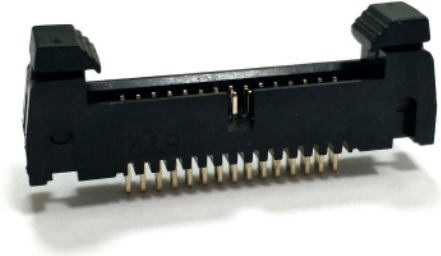

### SPECIFICATIONS

- Current Rating:  
1 Amps
- Voltage Rating:  
100V
- Insulator resistance:  
1000 Megohms Min.
- Contact Resistance:  
20m ohms Max
- Dielectric withstanding:  
AC 500 V
- Operating Temperature:  
-40° C - +105° C
- Contact Material:  
Brass
- Insulator Material:  
Nylon-6T UL 94V-0
- Color:Black
- Finish:  
Gold flash

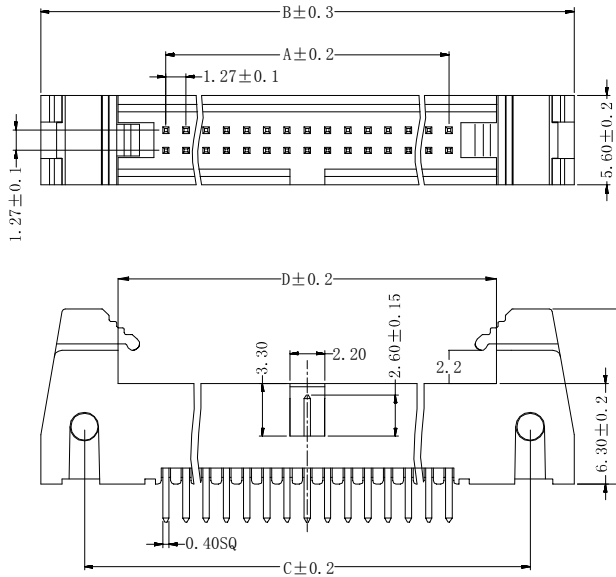

Recommended P.C.B. Layout

